

REV.	ECN NO	LOCATIONS	DESCRIPTION	DATE	REVISER	APPD

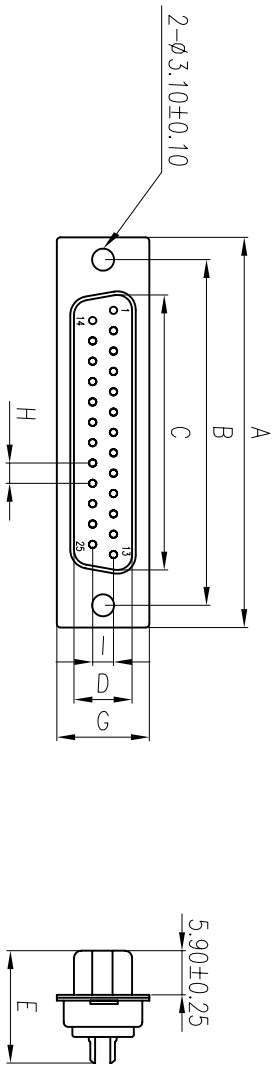

Note:

1.Material:

- 1.1 Insulator: P.B.T UL 94-V0 rated.
- 1.2 Contact: Brass,t=0.20mm.
- 1.3 Shell: Cold rolled steel,t=0.40mm.

2.Specification:

- 2.1 Current rating: 1 A Max.
- 2.2 Dielectric withstanding voltage: 500 V(ac) for 1 minute.
- 2.3 Contact resistance: 30 mΩ Max.
- 2.4 Insulation resistance: 1000 MΩ Min at DC 500V.
- 2.5 Total unmating force: 7.0 Kgf Max.
- 2.6 Total unmating force: 3.0 Kgf Min.
- 2.7 Temperature range: -55°C~+105°C

3.Finishes:

- 3.1 contacts:Gold flashed 1u”3u”5u”10U”15u”30u”.
- 3.2 Shell: Nickel,tin or gold plated

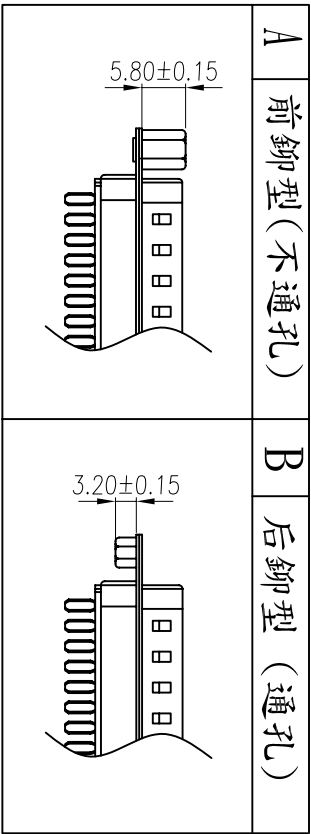

6	8.0 Nut	2	Brass	H4.75*8.0	Nickel Plated
5	3B Nut	2	Brass	H4.75*4.75	Nickel Plated
4	Back-shell	1	Cold Rolled Steel	T=0.40mm	Tin Plated
3	Front-shell	1	Cold Rolled Steel	T=0.40mm	Nickel Plated
2	Contact	9~37	Brass	T=0.20mm	Gold Flashed
1	Housing	1	P.B.T	UL 94-V0	Black/Blue/White
No.	Part Name	Q'ty	Material	Remarks & Thickness	Finish

PART NO	A±0.25	B±0.25	C±0.25	D±0.25	E±0.25	G±0.25	H±0.20	I±0.20
DS-09P	30.80	25.00	16.92	8.30	15.30	12.60	2.77	2.84
DS-15P	39.20	33.32	25.25	8.30	15.30	12.60	2.77	2.84
DS-25P	53.05	47.04	38.96	8.30	15.30	12.60	2.77	2.84
DS-37P	69.40	63.50	55.42	8.30	15.30	12.60	2.77	2.84

PART NO:		MATERIAL:	
MODEL NO:		FINSH:	
UNIT: mm	SIZE: A4	COLOR:	
TOLERANCE UNSPECIFIED	DR: 李霞	06/03/30	PART NAME:
.x ±0.3	CHK: Song	06/03/30	D-SUB SOLDER-體
.xx ±0.20	APP: Kent	06/03/30	DWG NO:
.xxx ±0.100			SCALE: 1:1
ANG. ±1°			SHEET: 1 of 1
			REV: A0